

Pos. Nr. Pos.no.	Beschreibung Description	Art.-Nr. Art.no.	Preisgruppe Price bracket
740102	DB-AG BR 515/815	=	N
740172		=	N
1	Gehäuse MW Betr. Nr. 515 529-6 Body ass. Loco no. 515 529-6	10740102	37
2	TS - Kinematikplatte Part set - Kinematics plate	146127	6
3	TS - Fenster MW Part set - Windows	146119	26
4	TS - Lichtleiter + Nägel Part set - Light conductor + nails	145517	6
5	Schneckensatz Worm gear set	145519	13
6	Motor m. Schwungm. + Litzen Motor w. flywheel + wires	145520	19
7	Platine MW PCB	65740103	19
8	Brückenstecker NEXT18 Jumper	149978	17
9	Schneckendeckel Worm gear cover	146129	6
10	Kardanwelle Cardan shaft	145523	3
11	Bodenplatte MW Floor	146130	13
12	Inneneinrichtung MW Interior fittings	145525	7
13	TS - Gehäuse Part set - Body	146120	7
14	Puffer rechts Buffer right	146122	3
15	Puffer links Buffer left	146123	3
16	Platine Innenbeleuchtung MW PCB interior lights	145541	16
17	Achse Axle	145529	4
18	Beilagscheibe Washer	112394	4
19	Antenne lang Antenna long	00197802	2
20	TS - Zughaken+Bremsskupplung Part set-Coupling hook+brake couplings	19733001	12
21	Kardanschale Cardan reception	145585	3
22	Achslager Axle bearing	145530	6
23	Kardanschale Motor Cardan reception f. motor	56740103	3
Sound			
24	Lautsprecher Loudspeaker	129524	13
25	Sounddecoder NEXT 18 Sound decoder	68159018	39
26	Platine MW Sound PCB for sound	657401731	20

Änderungen in Konstruktion und Ausführung vorbehalten
We reserve the right to change the construction and specification

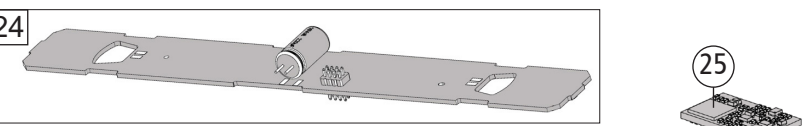
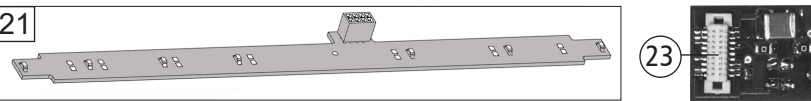
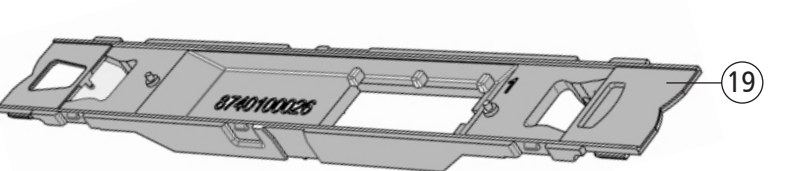
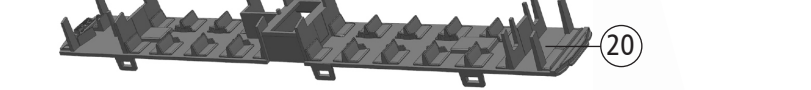
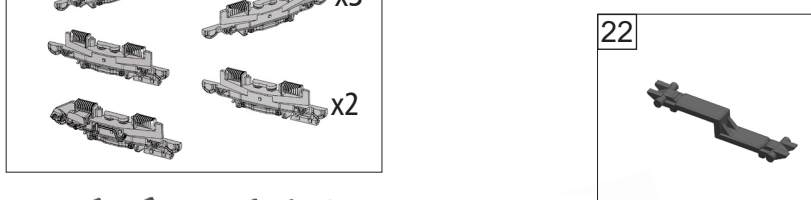
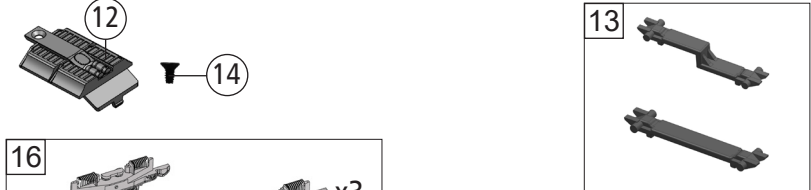
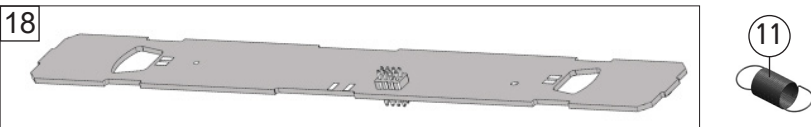
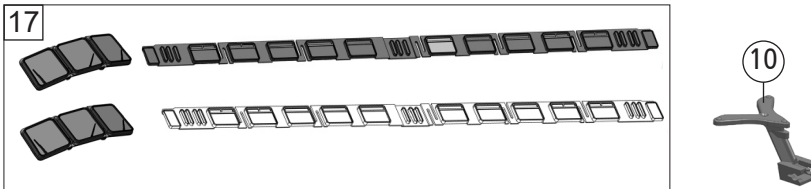
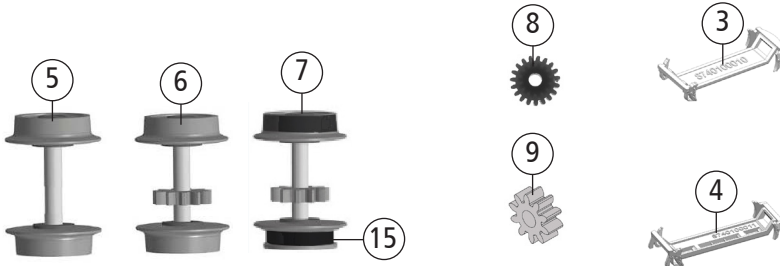
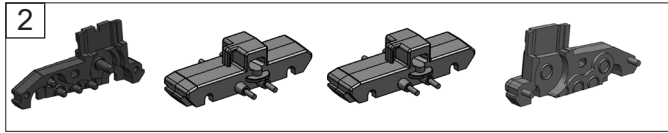

Pos. Nr. Pos.no.	Beschreibung Description	Art.-Nr. Art.no.	Preisgruppe Price bracket
740102	DB-AG BR 515/815	=	N
740172		=	N
1	Gehäuse SW Betr. Nr. 815 706-7 Body ass. Loco no. 815 706-7	10740172	36
2	Getriebe 3tlg. Gear set	145509	12
3	Drehgestellboden 1 Bogie bottom 1	146125	5
4	Drehgestellboden 2 Bogie bottom 2	146126	6
5	Radsatz o. Zahnrad o. Haftring Wheelset w/o gearwheel w/o tract. tyre	145511	10
6	Radsatz m. Zahnrad o. Haftring Wheelset w. gearwheel w/o tract. tyre	145512	11
7	Radsatz m. Zahnrad m. 2 Haftringe Wheelset w. gearwheel w. 2tract. tyres	145513	12
8	Schneckenrad Z=14 Wormgear wheel	86400	4
9	Zahnrad Z=10 Gearwheel	56717800	3
10	Kupplungsdeichsel Coupling reception	146128	6
11	Zugfeder Draw spring	109832	3
12	Decoderdeckel Decoder cover	146131	8
13	TS - Lokkupplung Part set - Coupling	146121	4
14	SK-Schraube M1,6x3 mm SK - Screw	125023	3
15	Haftring Traction tyre	00547001	1
16	TS - DG-Blende + Kontakt MW+SW Part set - Bogie frame + contact	146124	18
17	TS - Fenster SW Part set - Windows	146133	26
18	Platine SW PCB	65740173	17
19	Bodenpl. SW Floor	146134	7
20	Inneneinrichtung SW Interior fittings	145536	7
21	Platine Innenbeleuchtung SW PCB interior light	145537	15
22	Zurüstbeutel Bag of accessories	146135	5
23	Brückenstecker NEXT18 Jumper	149978	17
Sound			
24	Platine SW Sound PCB for sound	657401732	18
25	Lokdecoder Decoder	68740172	35

Ersatzteile erhalten Sie direkt unter www.fleischmann.de und bei Ihrem Fachhändler.
Spare parts can be ordered directly at www.fleischmann.de and from your local dealer.